



Booth Specifications/Elevation Schematics

Islands:

Exhibitors must submit island floor plan and elevation schematics for island booth space at NAEYC Conference **no later than October 17, 2024**. Contact [Debi Maines](#) at 856-302-0890 for additional information. Please be sure to include the height of your booth.

Signs and banners can be hung over island booths that are 400 square feet and above. They must be hung by authorized personnel and are subject to Show Management approval.

There is a 12-ft. floor-supported booth display height restriction with a 2-ft. easement between the top of the display and the bottom of the hanging banner. The bottom of the banner may not be lower than 16 ft. from the floor and no higher than 20 ft. from the floor. The purpose of this rule is to allow a clear line of vision between the display and the hanging banner. Additional floor structural support for hanging signs/apparatus is permitted from the island booth display but must be less than 3" in diameter/thickness and the hanging banner must still maintain a 2 ft. easement as stated above.

A fifty (50%) see-through effect on the portion of the booth from the floor up to a minimum of 8' in height is required. Compliance will be determined from a minimum of two angles. No exhibit structure may span an aisle by roofing or floor covering.

A twenty-five (25%) see-through effect on the portion of the booth from 8' up to a maximum height of 25' is required. Compliance will be determined from at least two angles.

Example of an Island Booth with Hanging Banner and Header
Top of Banner – 20' Limit (no higher)
Bottom of Banner – 16' Limit (no lower)

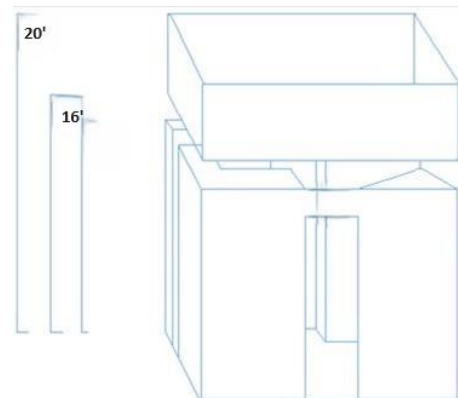

The schematics must clearly state the height in U.S. measurements (feet and inches) of each exhibit component. You must include the position of any hanging banners above the booth and indicate on schematics. Raised floors must also be indicated on the schematics.

Submit drawings to:

Debi Maines

A. Fassano & Company

Telephone: (856) 302-0893

Email: Debra_Maines@AFassanoCo.com

In-Line and Corner Booths

Display material for in-line and perimeter booths is restricted to a maximum height of 4' in the front 5' of the booth and 8' in the rear 5' of the booth. The back wall on is limited to 8' in height including signs or company name, logo, or product information. Each in-line and perimeter booth will have an 8' high draped background and 3' high drape divider defining the sides of the space. All in-line and perimeter booths must clear a ceiling height of 8'. **Hanging signs are not permitted.**

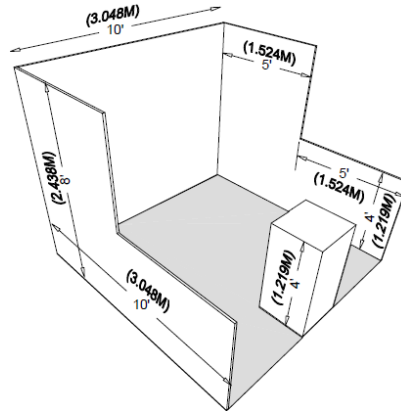

End Cap Booths:

An "endcap" is defined as a 10' x 20' space having 3 aisles faced toward the cross aisle at end of a row of traditional 10' x 10' linear booths. Certain restrictions apply to an endcap display. 1) Any portion of the exhibit bordering another exhibitor's booth must have the back side of that portion finished and must not carry identification signs or other copy that would detract from the adjoining exhibit; 2) the back wall is limited to 10 feet wide, 8 feet high centered across the 20-foot back wall area. All display fixtures over 42 inches high must be confined to those areas of the booth that are at least 5 feet from the aisle line to avoid blocking the sightline from the aisle to the adjoining booth. Exhibitors adjoining to an endcap exhibitor are entitled to the same reasonable sightline from the aisle as they would expect if they were adjacent to an exhibitor with a standard booth. **Hanging signs are not permitted.**

